

SALORA

VIDAA

INSTRUCTION MANUAL

models:

32XHV3300

43XFV3300

50XUV3300

IMPORTANT

Please read this manual carefully before installing and operating the TV

Keep this manual handy for further reference

Content

Safety Information	1
Important Safety Precautions	1
TV Buttons And Terminal Interface	2
External device connection diagram	2
TV Install And Connect	3
TV Stand Installation Instructions	3
OSD	4
First Time Installation	4
HOME	5
INPUT	5
Initial Setup	6
System	9
Media	11
Help	13
Specifications	14
Remote Controller	15

Safety Information



The exclamation point within an equilateral triangle is intended to alert the user to the presence of important operating in the literature accompanying the appliance.

CAUTION

**RISK OF ELECTRIC SHOCK
DO NOT OPEN**



Warning
The lightning flash with arrowhead symbol within an equilateral triangle, is intended to alert the user to the presence of uninsulated dangerous voltage within the product's enclosure that may be of sufficient magnitude to constitute a risk of electric shock to persons.

High voltages are used in the operation of this product. To reduce the risk of electric shock, do not remove cover of the cabinet, refer servicing to qualified service personnel.



If the TV any changes or coarse adjustment, electric shocks to be hurt, do not attempt to open a machine-maintenance, customer contact centres needed overhaul.

Important Safety Precautions

- 1) Read these instructions. 2) Keep these instructions. 3) Heed all warnings. 4) Follow all instructions.
- 5) Do not use this apparatus near water. 6) Clean only with dry cloth.
- 7) Do not block any ventilation openings. Install in accordance with the manufacturer's instructions.
- 8) Do not install near any heat sources such as radiators, heat registers, stoves, or other apparatus (including amplifiers) that produce heat.
- 9) Do not defeat the safety purpose of the polarized or grounding-type plug. A polarized plug has two blades with one wider than the other. A grounding type plug has two blades and a third grounding prong. The wide blade or the third prong are provided for your safety. If the provided plug does not fit into your outlet, consult an electrician for replacement of the obsolete outlet.
- 10) Protect the power cord from being walked on or pinched particularly at Plugs, convenience receptacles, and the point where they exit from the apparatus.
- 11) Only use attachments /accessories specified by the manufacturer.
- 12) Use only with the cart, stand, tripod, bracket, or table specified by the manufacturer, or sold with the apparatus. When a cart is used caution when moving the cart/apparatus combination to avoid injury tip-over.
- 13) Unplug this apparatus during lightning storms or when unused for long periods of time.



Caution:

- 14) To reduce the risk of fire or electric shock, do not expose this apparatus to rain or moisture.
- 15) The mains plug is used as disconnect device, the disconnect device shall remain readily operable.
- 16) The socket-out shall be installed near the equipment and shall be easily accessible.
- 17) This product should never be placed in a built-in installation such as a bookcase or rack unless proper ventilation is provided or the manufacturer's instructions have been adhered to.
- 18) The apparatus shall not be exposed to dripping or splashing and that no objects filled with liquid, such as vases, shall be placed on the apparatus.
- 19) Do not place any sources of danger on the apparatus (e.g. liquid filled objects, lighted candles).
- 20) Wall or Ceiling Mounting - The appliance should be mounted to a wall or ceiling only as recommended by the manufacturer.
- 21)  Never place the TV, remote control or batteries near naked flames or other heat sources, including direct sunlight. To prevent the spread of fire, keep candles or other flames away from the TV, remote control and batteries at all times.
- 22) The USB terminal should be loaded with 0.5 A under normal operation. These servicing instructions are for use by qualified service personnel only. To reduce the risk of electric shock do not perform any servicing other than that contained in the operating instructions, unless you are qualified to do so.
- 23) The battery shall not be exposed to excessive heat such as sunshine, fire or the like.
- 24)  This equipment is a Class II or double insulated electrical appliance. It has been designed in such a way that it does not require a safety connection to electrical earth.
- 25) The maximum using environment temperature is 45 degrees. The Maximum using altitude is 2000 meters

TV Buttons And Terminal Interface

TV Buttons

Note: The following is only functional schematic, And the actual position and arrangement of different models may be different.

One key:

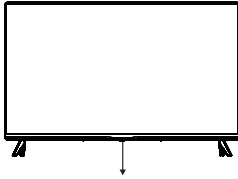

Press this button in standby mode to turn on / off the TV.

Seven keys:

	Turn ON/OFF Power.
	External Signal Input Selection.
	Display Main MENU And Confirm MENU Item Selection.
	Selecting Channel.
	Adjusting Volume.

Terminal Interface

Note: The following are the various terminal interface, the actual position and arrangement, the number of different models may be different.

	AV input External AV Signal Input		USB input Connect a USB device here to play its media files or to record programs via the PVR function.
	HDMI input Digital signal input from HDMI video connector.		OPTICAL output Connect the SPDIF receiver.
	ANT 75 Connect the antenna/cable tv input (75/VHF/UHF)		RJ45 Connect the Internet.



*Do not touch or be close to the HDMI, USB terminals, and prevent electrostatic discharge to disturb these terminals while in USB operation mode, or it will cause the TV to stop working or abnormal status.

External device connection diagram

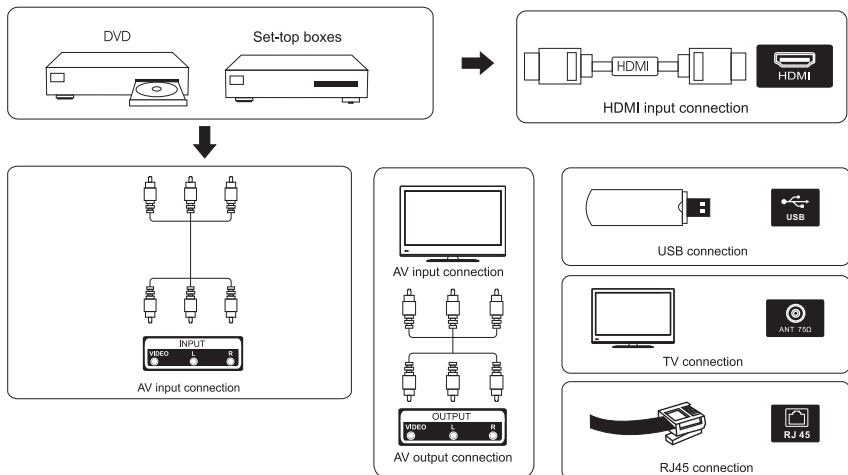

TV Install And Connect

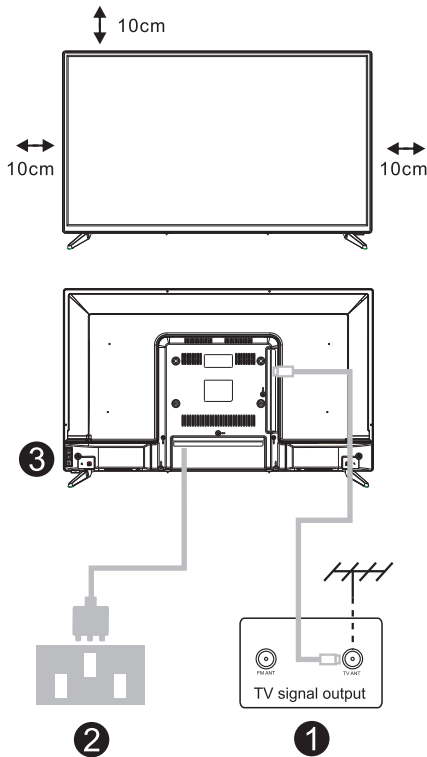

Set your TV

To put your TV on a firm place which can bear the weight of the TV.
To avoid danger, please don't positions the TV near water or heating place (such as light, candle, heating machine),do not block the ventilation at the back of TV.

Connect antenna and power

- 1.Connect the antenna cable to the antenna socket on the back of the TV.
- 2.To plug the power cord of TV (AC 100-240V~ 50/60Hz).

Turn on TV

- 3.Connect the power supply, enter the standby mode (red light), press the power button of the TV or the power button on the remote control to turn on the TV

Note: If the model has a CI card slot on its top, a silicone plug for the CI card slot can be found in the accessory bag (for models without CI card slot, there is no such silicone plug), please insert the silicone plug into the slot when the CI card is not in use.

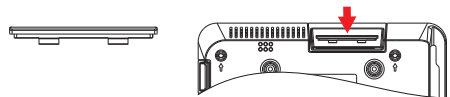

Note: Picture for reference purposes only.

TV Stand Installation Instructions

- 1.Open the carton and remove the TV and scattered accessories and base (some models without base).
- 2.In order to avoid damaging the TV,please cover it with soft mattress,put it on the table, face down on the soft material and screw the neck of the base to the TV.
- 3.screw the base and connected to the TV.
4. the installation is complete.

Note:

Picture for reference purposes only.
Please prevail in kind

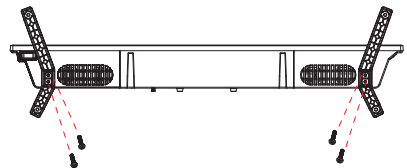

Suggestion:

To make it more convenient for base installation and to avoid any risk of scratches and damage, we advise you using the type of PH2 screwdriver.

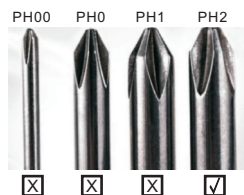

First Time Installation

First Time Installation

Please according to the Text Tip to First Time Setup.
Press [▼] / [▲] button to select Language.

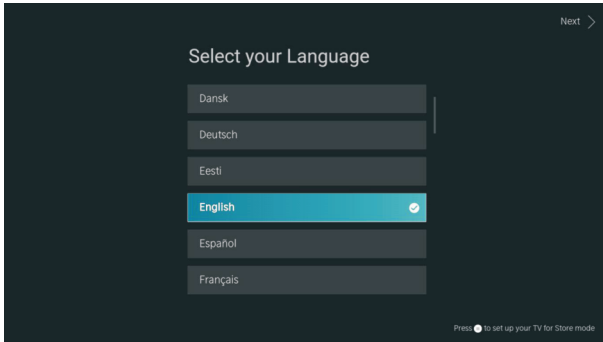

Please make sure the device has connected,
then press [▼] / [▲] / [◀] / [▶] button to select the primary input source

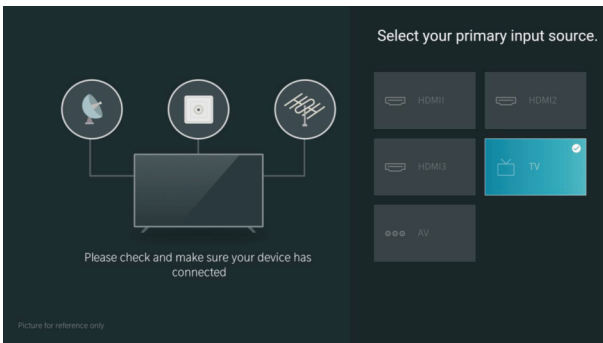



HOME

HOME

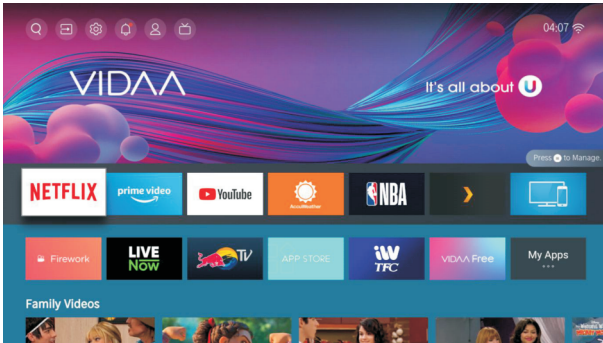
Press  button, you can enter HOME screen.



- You can always view the current time at the top of the Home screen.
- If your TV is connected to the Internet through a wireless connection or an Ethernet cable, then the icon  /  will be displayed at the top corner of the screen.
- Manage apps
- Select the item you want to move, then press the  button to manage.

INPUT

Input

- Press **[▼]** / **[▲]** button to select Inputs menu.
- Press **[▼]** / **[▲]** / **[◀]** / **[▶]** button to select.
- Press ENTER to select input.

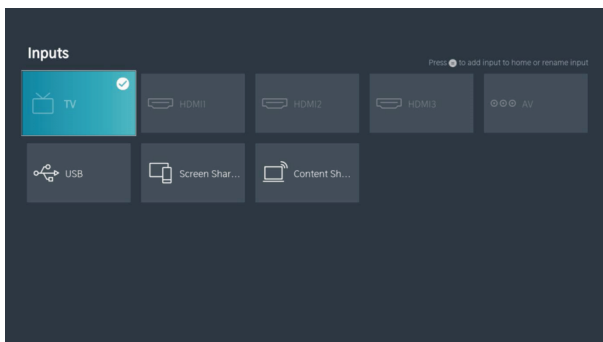

Initial Setup

Picture

Press **[MENU]** to enter the main menu, press **[▼]** / **[▲]** to select picture menu.

1. Press **[▼]** / **[▲]** button to select the option that you want to adjust in the PICTURE menu.
2. Press Enter button to adjust.
3. After finishing your adjustment, Press Enter button to save and return to the previous menu

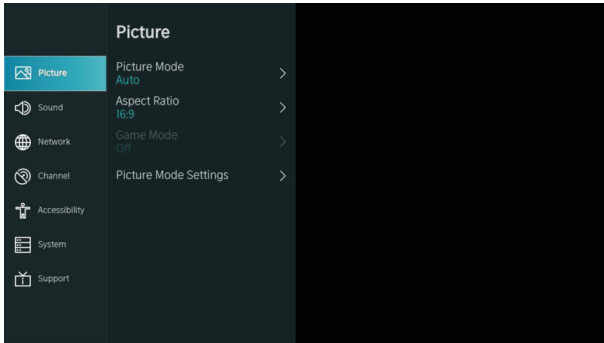

Picture Mode

Press **[▼]** / **[▲]** button to select Picture Mode, then press **[▼]** / **[▲]** & Enter button to select. (Optional: Standard/Cinema day/Cinema night/Dynamic/Sports).

Aspect Ratio

Adjust the Aspect Ratio to stretch or zoom in on your picture.

Press **▼** / **▲** button to select Aspect Ratio.

Press **◀** / **▶** button to select Automatic/16:9/4:3/Panoramic/Movie Zoom/Direct.

Game Mode

Press **[▼]** / **[▲]** to select, and press **[◀]** / **[▶]** to select On/Off.

Picture Mode Settings

Press **[▼]** / **[▲]** to select, and press **[▶]** & ENTER to enter.

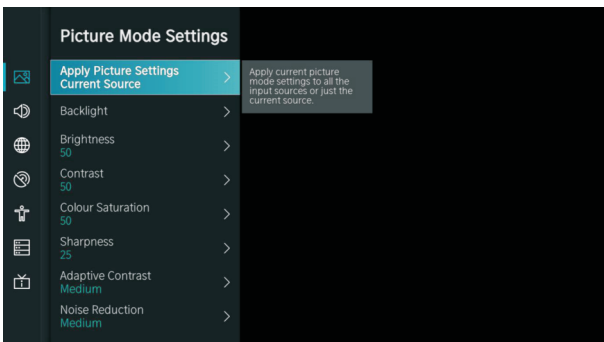

Initial Setup

Sound

Press MENU button to display the main menu. Press [▼] / [▲] button to select SOUND in the main menu,

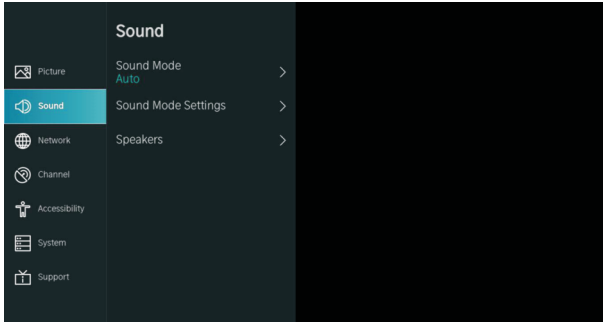

1. Press [▼] / [▲] button to select the option that you want to adjust in the SOUND menu.
2. Press Enter button to adjust.
3. After finishing your adjustment, Press Enter button to save and return to the previous menu.

Speakers

Press [▼] / [▲] button to select Speakers.
Press ENTER/ [▶] button to enter sub-menu

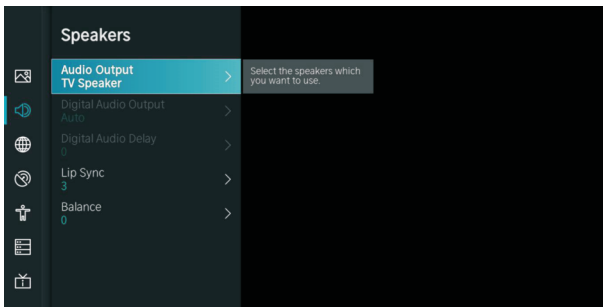

Audio Output

Press [▼] / [▲] button to select Speakers and enter, then press [▼] / [▲] button to select BT Sound Bar/ARC/TV Speaker/SPDIF Only

Network

Press MENU button to display the main menu. Press [▼] / [▲] button to select Network in the main menu

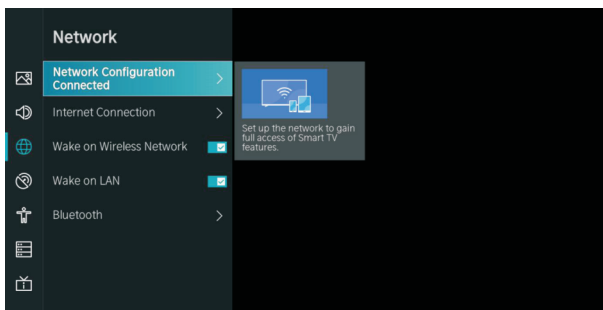

Initial Setup

Press [▼] / [▲] button to select :Network Configuration/Internet Connection/Bluetooth/ Wake on Wireless Network/Wake on LAN.

Channel

Press MENU button to display the main menu. Press [◀] / [▶] button to select Channel.

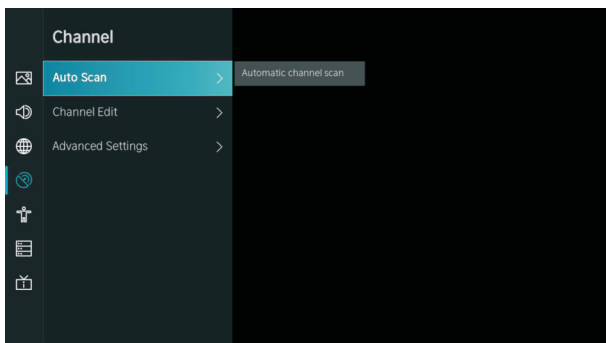

1. Press [▼] / [▲] button to select the option that you want to adjust in the Channel menu
2. Press Enter button to adjust.
3. After finishing your adjustment, Press Enter button to save and return to the previous menu.

Accessibility

Press MENU button to display the main menu.

Press [◀] / [▶] button to select Accessibility in the main menu.

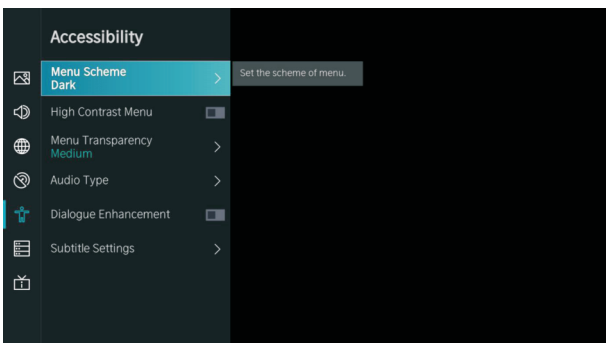

System

System

Press MENU button to display the main menu.

Press [◀] / [▶] button to select System in the main menu

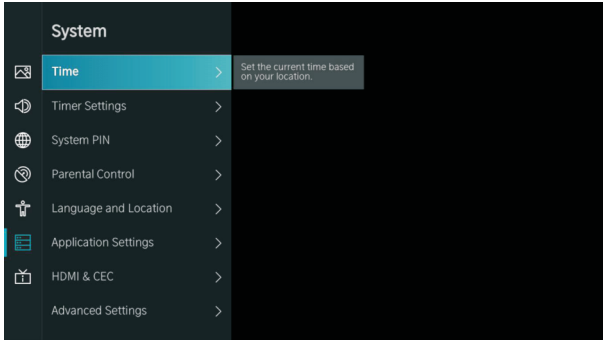

1. Press [▼] / [▲] button to select the option that you want to adjust in the System menu.
2. Press Enter button to adjust.
3. After finishing your adjustment, Press Enter button to save and return to the previous menu.

Application Settings

Press [▼] / [▲] button to select Application Settings

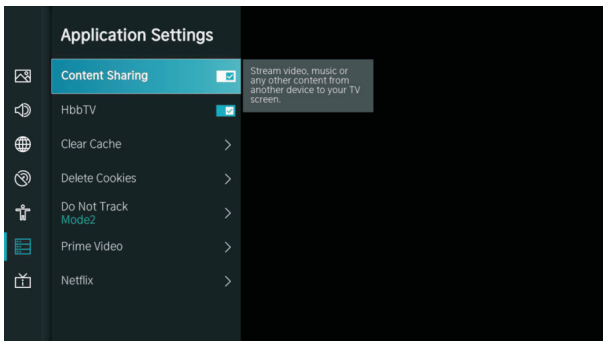

System

HDMI/CEC Function

Press **【▼】 / 【▲】** button to select CEC Function, then press Enter button to enter sub-menu to select.

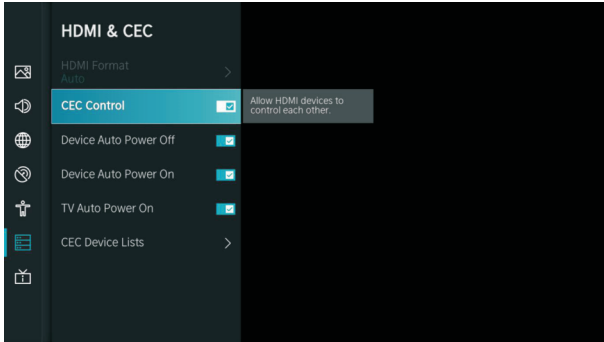

Press **▼ / ▲** button to select CEC Control/Device Auto Power On/Device Auto Power Off/TV Auto Power On/CEC Device Lists.

Note: All the Options are available only when the CEC Control select On.

Advanced Settings

Press **【▼】 / 【▲】** button to select Advanced Settings, then press ENTER / **【▶】** button to enter

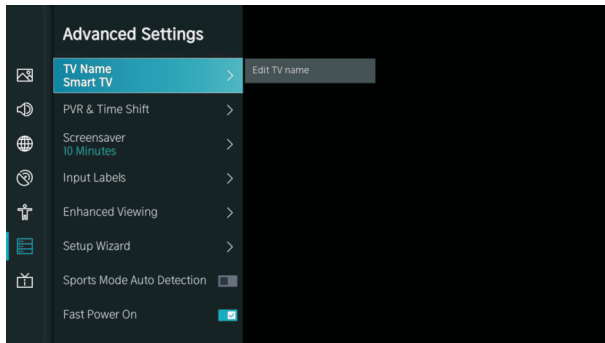

Support

Press **【▼】 / 【▲】** button to select Support, then press ENTER / **【▶】** button to enter

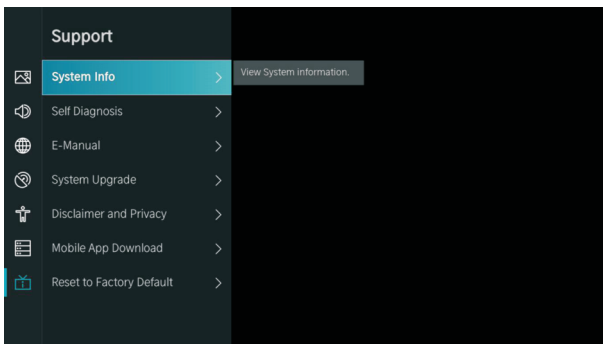

System

Restore To Factory Default

Press **【▼】 / 【▲】** button to select Restore To Factory Default, then press **ENTER/ 【▶】** button to enter sub-menu and select.

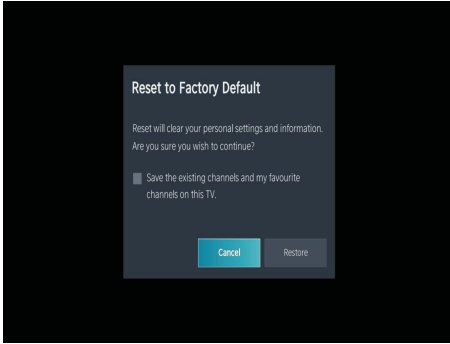

Media

Media

Press **【▼】 / 【▲】 / 【◀】 / 【▶】** button to select Media on the Home page or press **MEDIA** button on the remote, and press **OK** button to enter the Media Center.

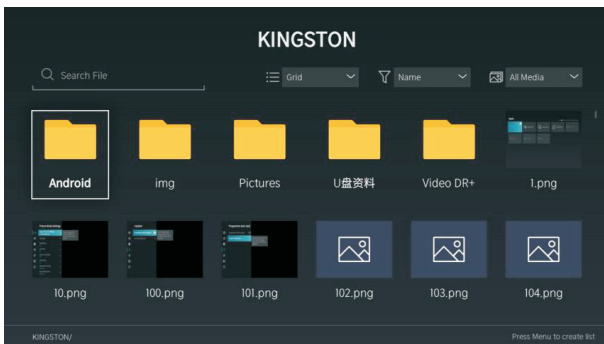

Media

Video

Press **[▼]** / **[▲]** button to select Video or All, and press **[▼]** / **[▲]** / **[◀]** / **[▶]** button to select Movies. Press Menu button to display the setting options on the left side.



Audio

Press **[▼]** / **[▲]** button to select Audio or All, and press **[▼]** / **[▲]** / **[◀]** / **[▶]** button to select Music.

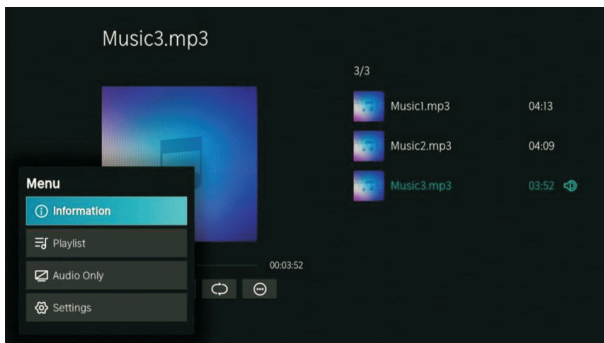

Image

Press **[▼]** / **[▲]** button to select Image or All, and press **[▼]** / **[▲]** / **[◀]** / **[▶]** button to select Picture.



Help

No power	<ul style="list-style-type: none"> ● Check if the AC cord of TV is plugged in or not. If there's still no power, please disconnect the plug, and reconnect to the socket after 60 seconds. Turn the power back on.
Signal not received properly	<ul style="list-style-type: none"> ● Double or phantom images may appear on your TV if there are high buildings or mountains close to where you are. You can adjust the image thru manual operation: consult instruction of vernier regulation, or adjust the direction of the external antenna. ● If you use an indoor antenna, signal reception may be more difficult under certain circumstances. Adjust the direction of the antenna for optimum reception. If this does not improve reception, you may have to switch to an external antenna.
No picture	<ul style="list-style-type: none"> ● Check if the antenna at the back of the TV is connected properly. ● View other channels to see if the problem still occurs.
Video appears with no audio	<ul style="list-style-type: none"> ● Try increasing the volume. ● Check if the TV's sound is on mute or not.
Audio is present, but video does not appear or is discolored	<ul style="list-style-type: none"> ● Try adjusting the contrast and brightness.
Static noise affects video and audio quality	<ul style="list-style-type: none"> ● Check if the antenna at the back of the TV is connected properly.
Broken lines on screen	<ul style="list-style-type: none"> ● Electrical appliances such as hair dryers or vacuums etc. may be interfering with your TV set. Switch these appliances off.
Remote doesn't work	<ul style="list-style-type: none"> ● Make sure the plastic bag which came with the remote control is removed. Try using the remote in a shorter distance from the TV. Check if the placement of the batteries is correct, or try using new batteries with the remote control. ● The TV will go into Standby mode if it receives no response in a few minutes.
No video (PC mode)	<ul style="list-style-type: none"> ● Please check if the cable is connected to the HDMI port correctly, or if the cable is bent in some places.
Screen is too bright or dark (PC Mode)	<ul style="list-style-type: none"> ● Adjust the brightness or contrast in the main menu.
No response from the PC	<ul style="list-style-type: none"> ● Check if the PC's display resolution is set to a compatible resolution for the TV.
Lines appearing when a device is connected to the RCA port	<ul style="list-style-type: none"> ● Make sure you are using a cable in good quality.
Problems are unresolved	<ul style="list-style-type: none"> ● Unplug the power cable and wait for 30 seconds, then reconnect to the socket. If problems still persist, do not attempt to repair the TV by yourself. Kindly contact the service center.

Do not leave your TV displaying a static image, whether it is from a paused video, menu screen, etc. for an extended period of time, doing so will damage the display and may cause image burn-in.

Specifications

Screen Size	power Consumption	Main accessories
24"	30W/36W	User's manual x1 Remote controller x1 Power cord x1 AAA Batteries x2 (Optional)
32"	40W/56W	
39"	60W/70W	
40"	60W/70W/90W	
42"	65W/70W/90W	
43"	70W/80W/90W	
50"	100W/108W/120W	
55"	110W/118W/135W	
58"	120W/135W/160W	
65"	160W/165W/190W	
75"	230W/250W/260W/270W	

★ LIFE TIME : 60,000 Hrs



Manufactured under license from Dolby Laboratories.
 Dolby, Dolby Audio, and the double-D symbol are trademarks of Dolby Laboratories Licensing Corporation.



The terms HDMI and HDMI High-Definition Multimedia Interface, and the HDMI logo are trademarks or registered trademarks of HDMI Licensing LLC in the United States and other countries.

WARNING

Never place a television set in an unstable location. A television set may fall, causing serious personal injury or death.

Many injuries, particularly to children, can be avoided by taking simple precautions such as:

1. Using cabinets or stands recommended by the manufacturer of the television set.
2. Only using furniture that can safely support the television set.
3. Ensuring the television set is not overhanging the edge of the supporting furniture.
4. Not placing the television set on tall furniture (for example, cupboards or bookcases) without anchoring both the furniture and the television set to a suitable support.
5. Not placing the television set on cloth or other materials that may be located between the television set and supporting furniture,
6. Educating children about the dangers of climbing on furniture to reach the television set or its controls.

If your existing television set is being retained and relocated, the same considerations as above should be applied.

Wall-mounted screw: 22-24inch M4, 28-70inch M6, 75inch M8

Note: don't hang at an angle to avoid the risk of falling off.

Remote control

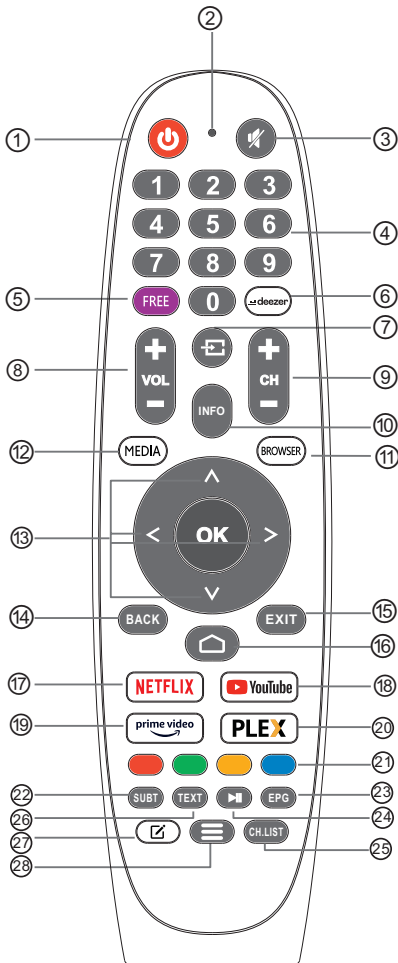

- ① **POWER**: Switches the TV between on and standby mode.
- ② No effect.
- ③ **MUTE**: Mute or restore your TV sound.
- ④ **0-9**: Figures "0-9" are used to directly input channel number.
- ⑤ **FREE**: Connects to FREE.
- ⑥ **deezer**: Connects to deezer.
- ⑦ **Inputs**: Display/Select signal source options.
- ⑧ **VOL +/-**: Press to increase / decrease the sound level.
- ⑨ **CH +/-**: Press to scan through channels.
- ⑩ **INFO**: Displays the present channel information such as the current time and channel name.
- ⑪ **BROWSER**: Connects to BROWSER.
- ⑫ **MEDIA**: Connects to MEDIA
- ⑬ **Navigation buttons**: Cursor UP/LEFT/RIGHT/DOWN.
- ⑭ **BACK**: Press to move back through menus.
- ⑮ **EXIT**: Exit the OSD menu.
- ⑯ **HOME**: Displays the home screen.
- ⑰ **NETFLIX**: Connects to NETFLIX for viewing online TV shows and films (internet connection required).
- ⑱ **YouTube**: Connects to YouTube (internet connection required).
- ⑲ **Prime video**: Connects to Prime video (internet connection required).
- ⑳ **PLEX**: Connects to PLEX.
- ㉑ **COLOR BUTTONS**: There are related functions under EPG.
- ㉒ **SUBT**: SUBT.
- ㉓ **EPG**: EPG menu.
- ㉔ **Media control**: Play / Pause
- ㉕ **CH.LIST**: Channel list
- ㉖ **TXT**: Press to enter Teletext when play the program.
- ㉗ **App customization**: App customization (long press under the home page)
- ㉘ **Menu**: Displays the OSD (On Screen Display) menu.