



SHARP

Quick Start Set Up Guide

For information on using the TV's features, please refer to the Operating Instructions.

Model Numbers

- 42EE2K
- 42EE4K
- 42EE6K
- 42EE7K

Register your manufacturers guarantee online within 14 days of purchase at www.registertoday.co.uk/sharp and enter into a prize draw to

Win a **SHARP** Soundbar

Technical Specification

	42EE2K 42EE4K 42EE6K 42EE7K
Energy Efficiency Class (SDR)	F
Power consumption (SDR)	42 W
Screen resolution (pixels)	1920 x 1080
Screen Size (diagonal)	106 cm / 42 inches
RF	75 ohm Antenna / Analog / DVB / Satellite
Inputs	3 x HDMI • 2 x USB • 1 x Micro SD card slot 1 x RJ45 LAN/Ethernet • 1 x Composite/CVBS Video & Component/YpPr Input 1 x L/R Audio input for Composite/CVBS & Component/YpPr
Sound Outputs	1 x Digital Optical Audio output, 1 x 3.5mm Headphone
Speaker*/ Amplifier Watts (RMS)	2 x 10 / 2 x 8
Voltage and power consumption	AC 220V ~ 240V; 50Hz 42/65/85W (home mode/standard/max) (<0.5W in Standby)
Dimensions including stand (mm)	953W x 576H x 185D
Net weight (Kgs)	6.7
Wall Mounting	VESA 200 x 200 (mm)

*Built-in Harman Kardon speaker systems (Full-range speaker and tweeter).

SOUND SYSTEM BY harman/kardon

Harman Kardon is trademark of HARMAN International Industries, Incorporated, registered in the United States and/or other countries.

HDMI

The terms HDMI, HDMI High-Definition Multimedia Interface, HDMI trade dress and the HDMI Logos are trademarks or registered trademarks of HDMI Licensing Administrator, Inc.

Dolby Audio

Manufactured under license from Dolby Laboratories. Dolby, Dolby Audio, and the double-D symbol are trademarks of Dolby Laboratories Licensing Corporation.

Quick & easy guide for setting up your TV

What is included in the box

Using the remote control

Setting up the TV for the first time - including attaching the stand

Connecting other devices to the Television

Need help setting up or using your TV?

Please contact the UK & ROI Helpline*

Telephone UK 0330 024 0803 or ROI 01443 3323

Online support at: www.umc-uk.co.uk

Email support at: service@umc-uk.co.uk

*Calls to 0330 numbers are charged at standard call rates and are included as part of any bundled minutes with your phone provider. Hours are correct at time of this document being published. Please note these hours are subject to change periodically. Calls to the ROI number are charged at the local call rate.

The telephone opening hours are:

Monday to Friday: 8.30am – 6pm

Saturday: 9am – 5pm

Bank Holidays: 10am – 4pm

Closed Christmas and New Years day.



If you wish to use your Sky remote to operate the TV's basic functions, you will need a Sky remote control (Revision 9 or later) and you will need to program it with the code 2134. If you wish to use your Sky Q remote to operate the TV's basic functions, you will need to program it with the code 4170.

Sky Remote Code



- 1 **STANDBY** - Switch on the TV when in standby or vice versa.
- 2 **FREEVIEW PLAY** - Access the Freeview Play app.
- 3 **NUMBER BUTTONS** - 0-9 to select a TV channel directly.
- 4 **MUTE** - Mute the sound or vice versa.
- 5 **TV GUIDE** - Opens the 7 day TV guide (digital TV mode).
- 6 **VOL (+/-)** - To increase/decrease the sound level.
- 7 **PICTURE** - Scrolls through picture mode options.
- 8 **SOUND** - Scrolls through sound mode options.
- 9 **SOURCE** - To display the input/source menu.
- 10 **CH (+/-)** - To increase or decrease the channel being watched.
- 11 **EXIT** - To exit all menus.
- 12 **MENU** - To display OSD menu.
- 13 **INFO** - Press once for now/next channel information.
- 14 **TEXT** - To enter/exit Text.
- 15 **SUBTITLE** - To switch the dialogue at the bottom of the screen (on/off).
- 16 **YOUTUBE** - Access the YouTube App.
- 17 **NETFLIX** - Access the Netflix App.
- 18 **APPS** - Access the APPS menu.
- 19 **RECORD** - Access the USB record function.
- 20 **REC LIST** - Opens the list of previously recorded items.
- 21 **REPEAT** - To repeat playback.
- 22 **ANGLE** - Select different angle of DVD.
- 23 **GOTO** - To go to a specific chapter.
- 24 **A-B** - Press once to set point, press a second time to return to point.
- 25 **REPEAT** - To repeat playback.
- 26 **MI** - To play/pause.
- 27 **MI** - To play in fast forward mode.
- 28 **MI** - To play in fast rewind mode.
- 29 **MI** - To stop the playback/Eject Disc.
- 30 **MI** - To advance forward to the next chapter.
- 31 **MI** - To restart the current chapter.
- 32 **MI** - To restart the current chapter.

Please save your box/packaging as you will need this in the event of warranty/service repair or support. We are unable to carry out warranty/service if you are unable to package it correctly. The safest way to package your item in the event of warranty/service repair is in its original box/packaging.

Note that to use the full functionality of Freeview Play your set must be connected to the internet.

Alternative means of searching. Freewiew Play brings together live TV viewing with "catch up" TV services such as BBC iPlayer, ITV Player, More4 and Demand 5. The Freewiew Play Explore app features a carousel of genres to select from when searching for programmes, such as sport, comedy, dramas and soaps, etc. Content is made up from recommendations of the major broadcasters and offers an alternative means of searching.

Microsoft PlayReady™ content access technology to protect their intellectual property, including copyrighted content. This device uses PlayReady technology to access PlayReady-protected content and/or WMDRM-protected content. If the device fails to properly enforce restrictions on content usage, content owners may require Microsoft to revoke the device's ability to consume PlayReady-protected content. Revocation should not affect unprotected content or content protected by other content access technologies. Content owners may require you to upgrade PlayReady to access their content. If you decline an upgrade, you will not be able to access content that requires the upgrade.

This product contains technology subject to certain intellectual property rights of Microsoft. Use or distribution of this technology outside of this product is prohibited without the appropriate license(s) from Microsoft.

Microsoft PlayReady™



RF Cable

If you don't have the RF cable shown below, then you can purchase one from www.umc-uk.co.uk/cables or from your local retailer. If you are intending to connect your TV to an RF socket in order to receive Freeview you will need this cable.

Additional Accessories

- 1 x Quick Start Guide
- 1 x Remote Control and 2 x AAA Batteries
- 1 x Safety Leaflet
- 1 x Stand installation pack

Included with this TV are the following accessories

What is included in the box

To launch the Online Manual, press the [MENU] button and then select **Settings > Setup > Help Information**

Online Manual

REMOTE CONTROL

Setting up the TV set for the first time

1 Fitting the stand

TV panel must be facing downwards.

For the stand installation, there is one type of screw provided as shown below.

Note: To complete the stand installation you will require a cross head screw driver.

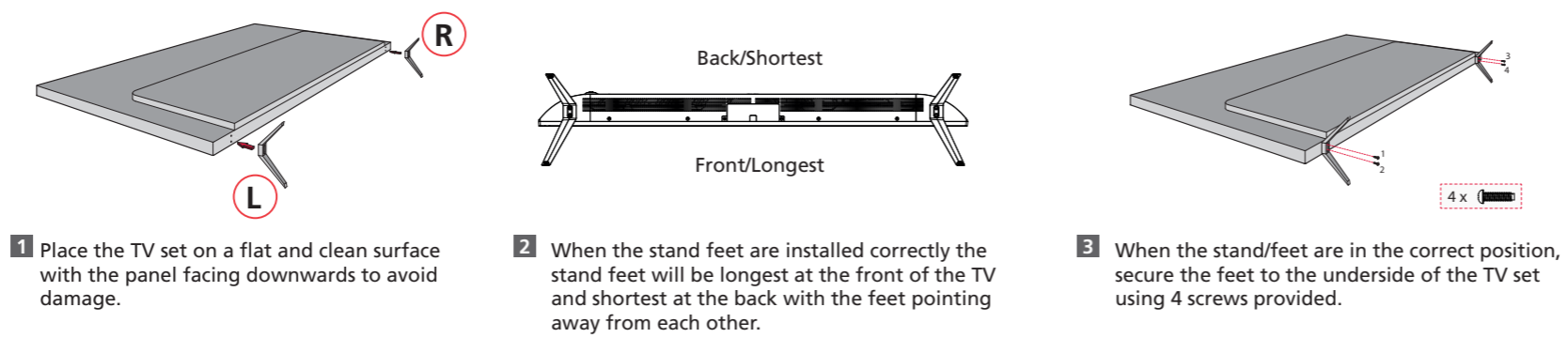
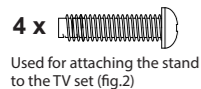

- Place the TV set on a flat and clean surface with the panel facing downwards to avoid damage.
- When the stand feet are installed correctly the stand feet will be longest at the front of the TV and shortest at the back with the feet pointing away from each other.
- When the stand/feet are in the correct position, secure the feet to the underside of the TV set using 4 screws provided.

Win a SHARP Soundbar

Register your manufacturers guarantee online within 14 days of purchase at www.registertoday.co.uk/sharp and enter into a prize draw to win a Sharp Soundbar. Terms and conditions apply. Online registration only.



2 Connecting your set

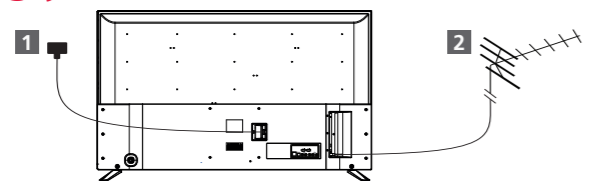

- Connect the TV to your power socket.
- If you wish to use the TV to receive Freeview/Saorview channels, connect the RF input from the TV to your outdoor Digital TV aerial. If you do not wish to receive Freeview/Saorview, skip this step.

3 Powering On the TV



Switch on the television by pressing the TV control stick located on the TV set.

Remote Control: Installing Batteries

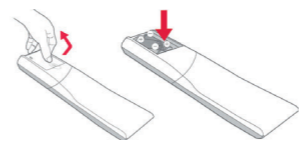

Insert the batteries supplied into the remote control and press the standby button to power on the TV.

Wall Mounting the TV

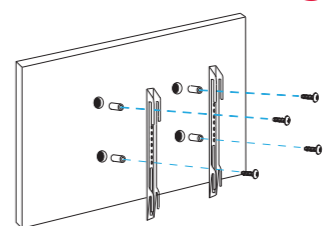

- Remove the four screws that are supplied in the wall mounting holes.
- The wall mount can now be easily attached to the mounting holes on the rear of the TV.
- Install the wall mounting bracket to the television as advised by the bracket manufacturer.

Image for illustration only. For the dimensions of the VESA mounting, please refer to the Technical Specifications section of this document.

The picture shows the use of spacers, which are not applicable to all sets/installations.

4 First time installation

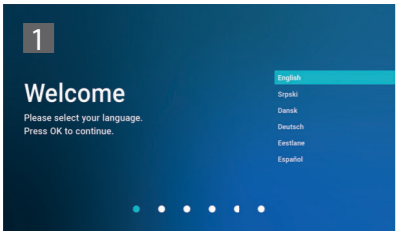

Introduction & Language

When the set first turns on, it enters the First Time Installation mode. This can be restarted by restoring the set to default settings in the 'About TV' Menu. Select your preferred on-screen display language. This will change the language in which the menus and associated information is displayed in.

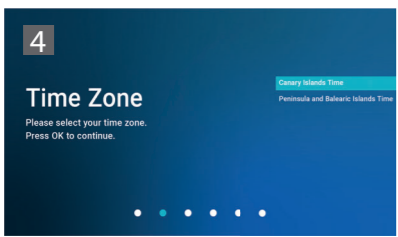

Time Zone

Set the Time Zone in which the TV will reside. This may be dependent on the country you select in step 2.

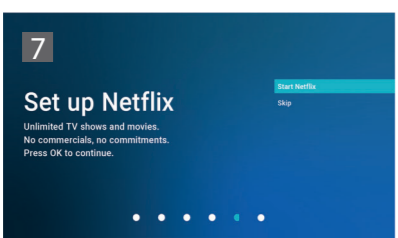

Set up Netflix

If you have a Netflix account, it can be set up on the television here. Once set up and validated, the First Time Installation returns to the next step.

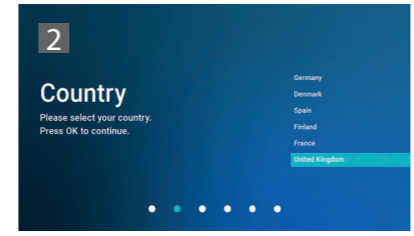

Country

Select the correct country in which the set will be used in. This will enable the set to correctly install the functions applicable in the country of use.



Updates Notice

You will need to agree to certain information collection for the TV set to operate as intended.

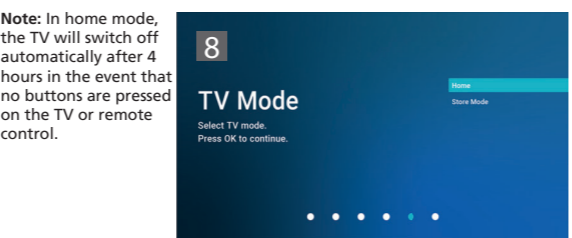

TV Mode

Note: In home mode, the TV will switch off automatically after 4 hours in the event that no buttons are pressed on the TV or remote control.

Home Mode: For normal use, by default it is set to a power saving mode which reduces the energy used by up to 25% (by reducing the power to the LED/LCD panel). This can be changed in the picture mode settings.

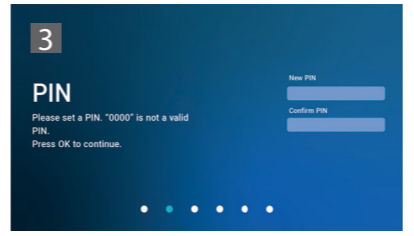

PIN

This needs to be set to establish parental controls.

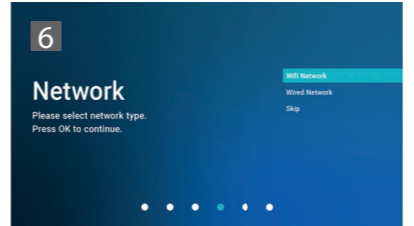

Network Set Up

You can connect the TV to your broadband router or wireless network in order to take advantage of the Smart functions. If you connect the TV to your router using an Ethernet cable, the Wifi set up will be skipped.

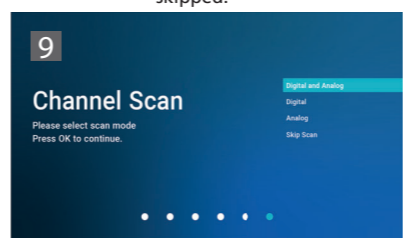

Channel Scan

Choose to install terrestrial channels via Digital or Analog signals. **Note:** Analog signals in the United Kingdom have been turned off. Only Digital signals are available.

Connectivity

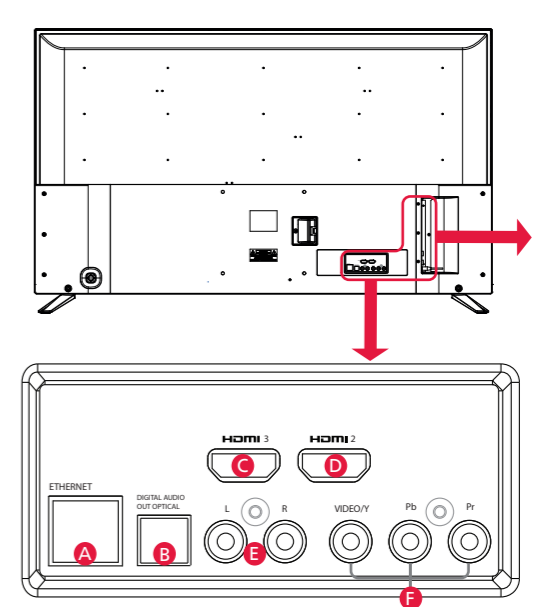

A Ethernet/LAN*	Network Connection	H RF In	RF / TV Aerial input
B Digital Audio	Digital Optical Audio Output	I HDMI 1 (ARC)	HDMI Input with ARC
C HDMI 3	HDMI Input	J Earphones	Earphones Input
D HDMI 2	HDMI Input	K Service Input	Input is used only by service centres
E L/R	Audio shared for video/ Composite and component/YPbPr	L CI Card In	Common Interface Module
F Video/YPbPr	Video Input (green) and HD input (Ypbpr)	M TF Card In	Micro SD Card Input
G SAT In	Satellite Input	N USB 2.0	USB 2.0 input x2